

# 3/16" Mobile J-Pole Antenna

A	292/F	Distance in Inches Center to Center
B	510/F	Height in Inches
C	8424/F	Height in Inches
D	2809/F	Height in Inches
E	1805/F	Number of Turns Insulated Solid AWG#14 Copper

**KR6/KR7KZ**  
**1972**  
**Okinawa, Japan**  
**U.S. Army**

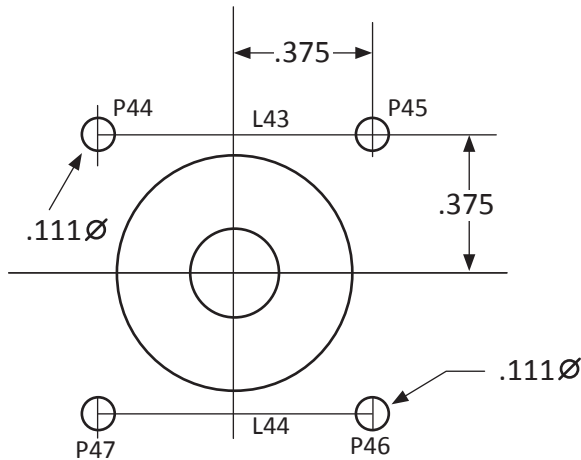

3/16" 2-Meter J-Pole Base Plate  
 For 3/16" Stainless Steel Rods  
 $P41 + P40 = 3/16"$   
 $P44 - P47 = .440"$

